

Ben 2 and Ben3 – Fuelwood Stoves

Annex A)

Drawings Ben 2 and Ben 3 and List of Parts

http://solarcooking.wikia.com/wiki/Ben_3_Firewood_Stove

Content Annex A)

Fig. 1. Assembly Drawing: Front views and top views Ben 2

Fig. 2. Details Ben 2 and Ben 3: Ash Pan (1) and Grate Bar (2)

Fig. 3a. Details Ben 2: Stove Shell (3)

Fig. 3b. Details Ben 3: Stove Shell (3)

Fig. 4. Details Ben 2 and Ben 3: Tripod (4); **a tripod made of round steel, see Annex E) is recommended. Annex E) contains the documentation about this tripod and its production**

Ben 3 Stove Shield (optional)

List of Parts Ben 2 and Ben 3

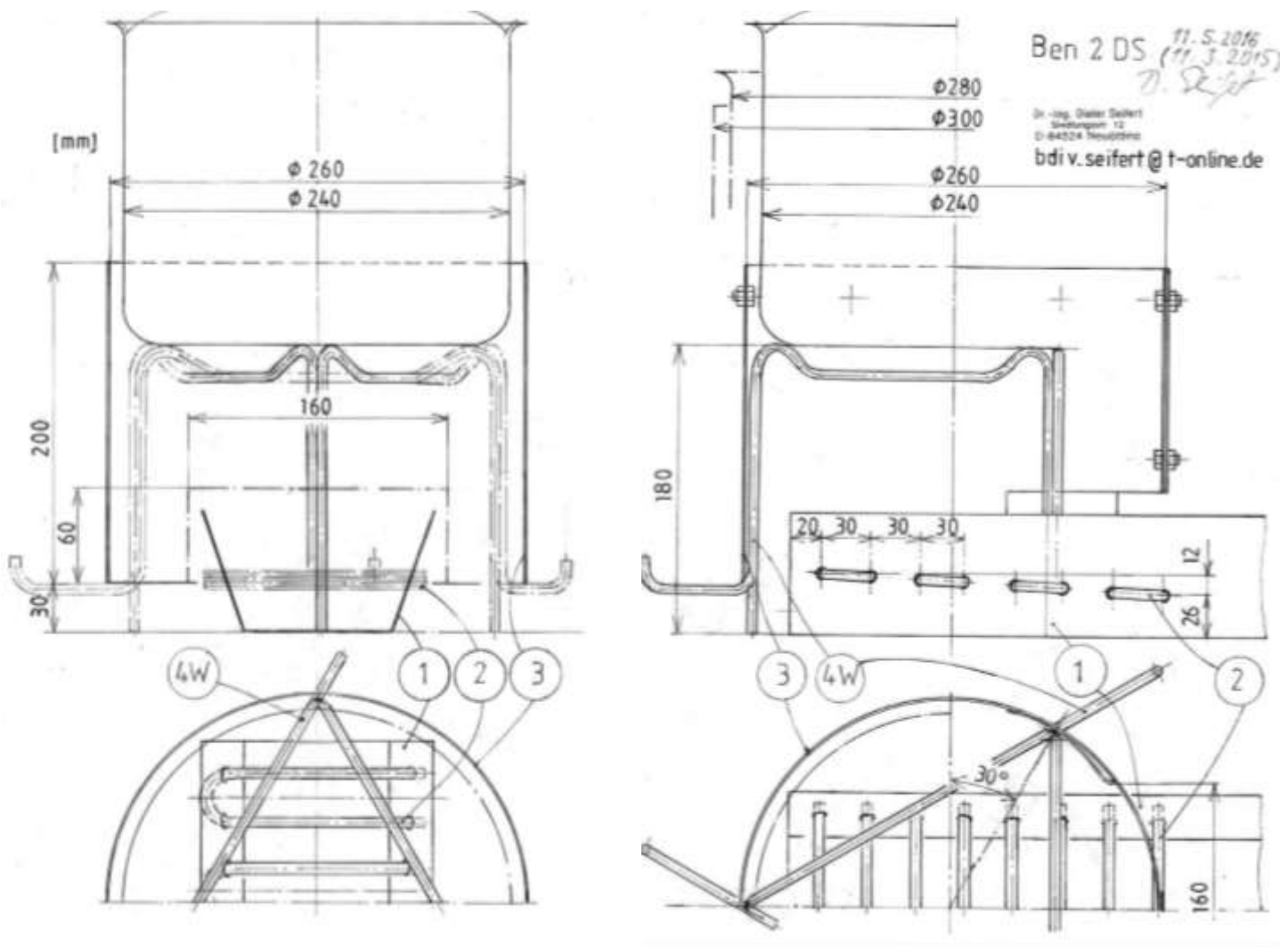

Fig. 1. Assembly Drawing: Front views and top views Ben 2 (May 2016)

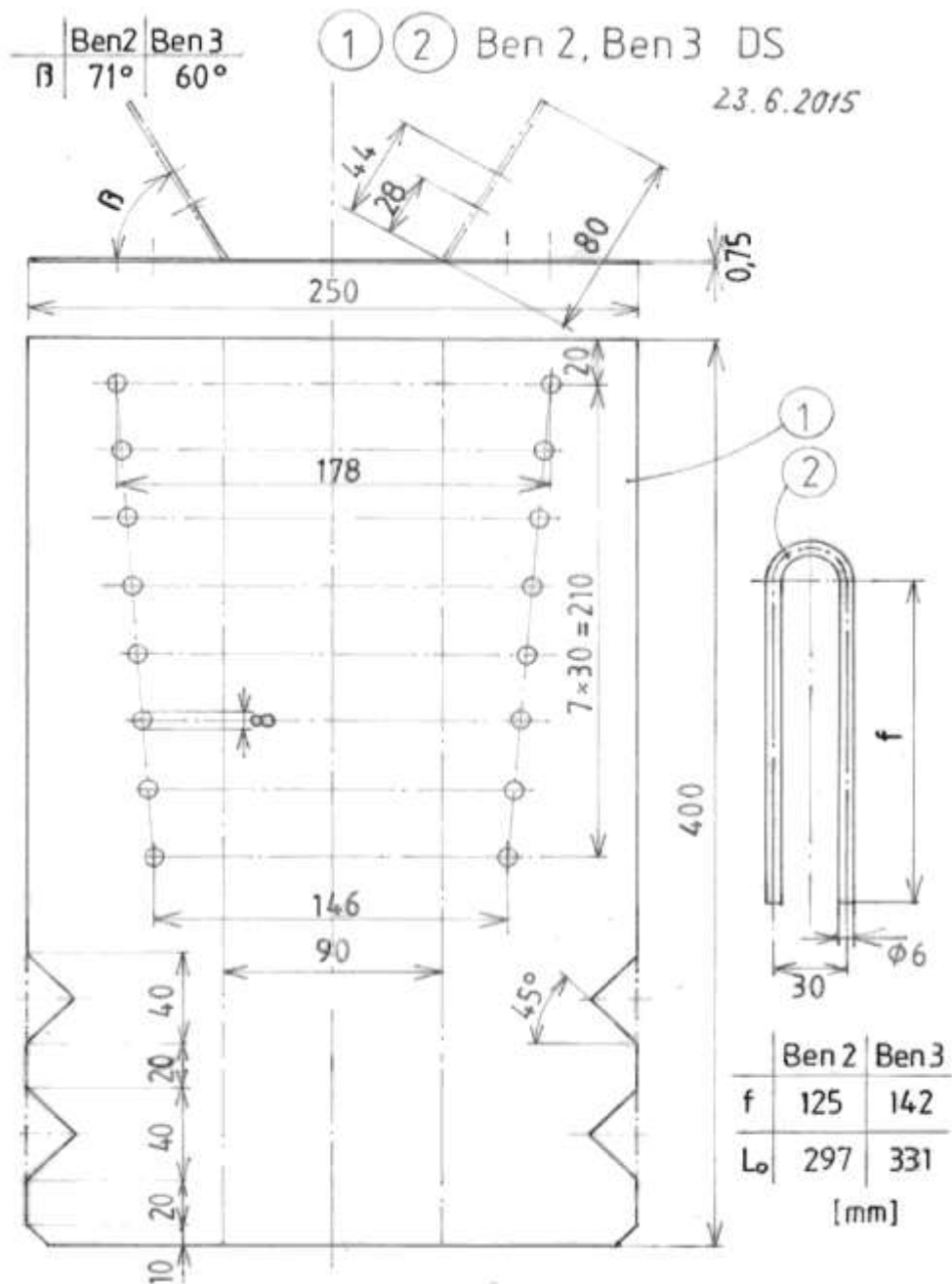

Fig. 2. Details Ben 2 and Ben 3: Ash Pan (1) and Grate Bar (2)
(April 2015 and May 2016)

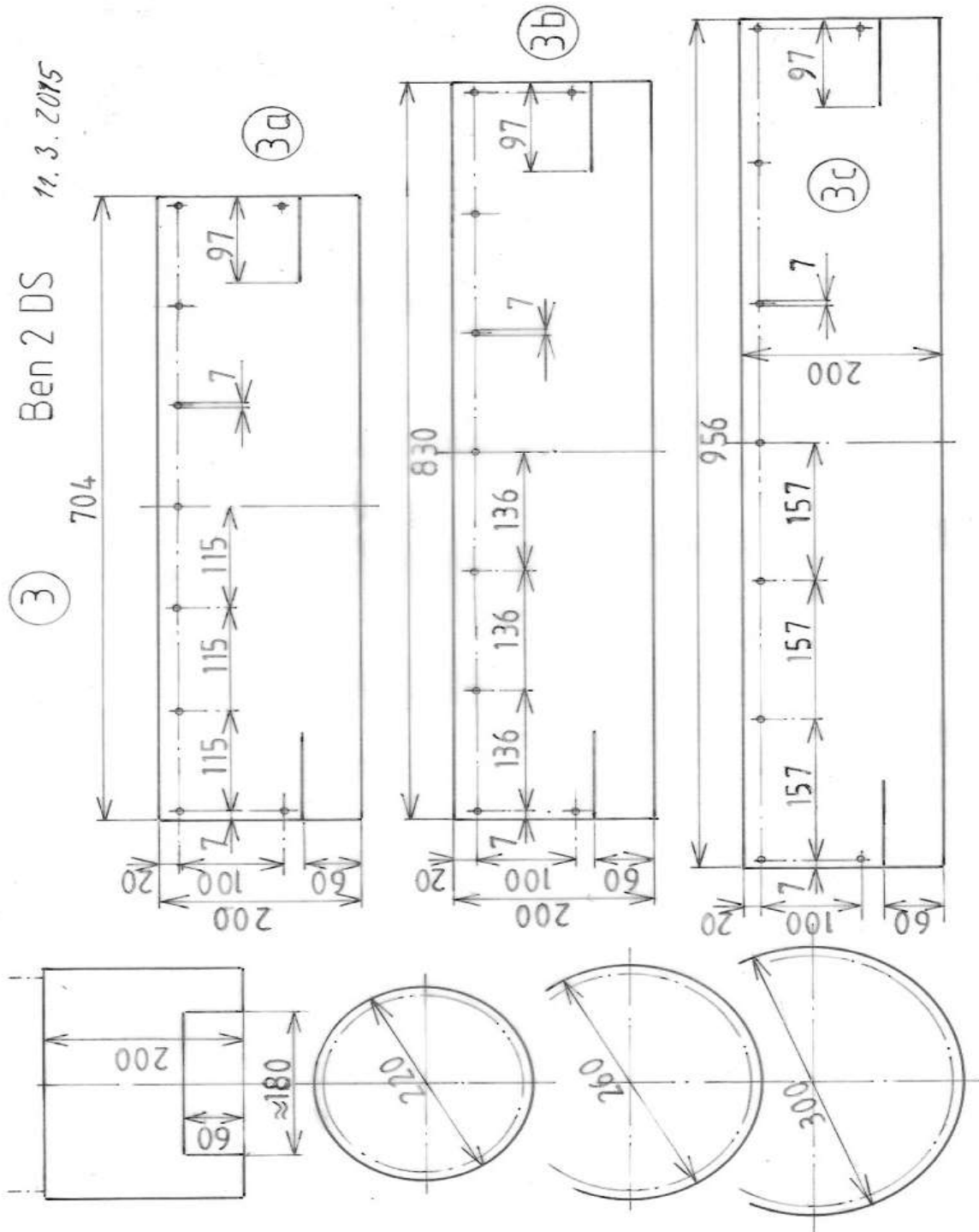

Fig. 3a. Details Ben 2: Stove Shell (3)
(April 2015 and May 2016)

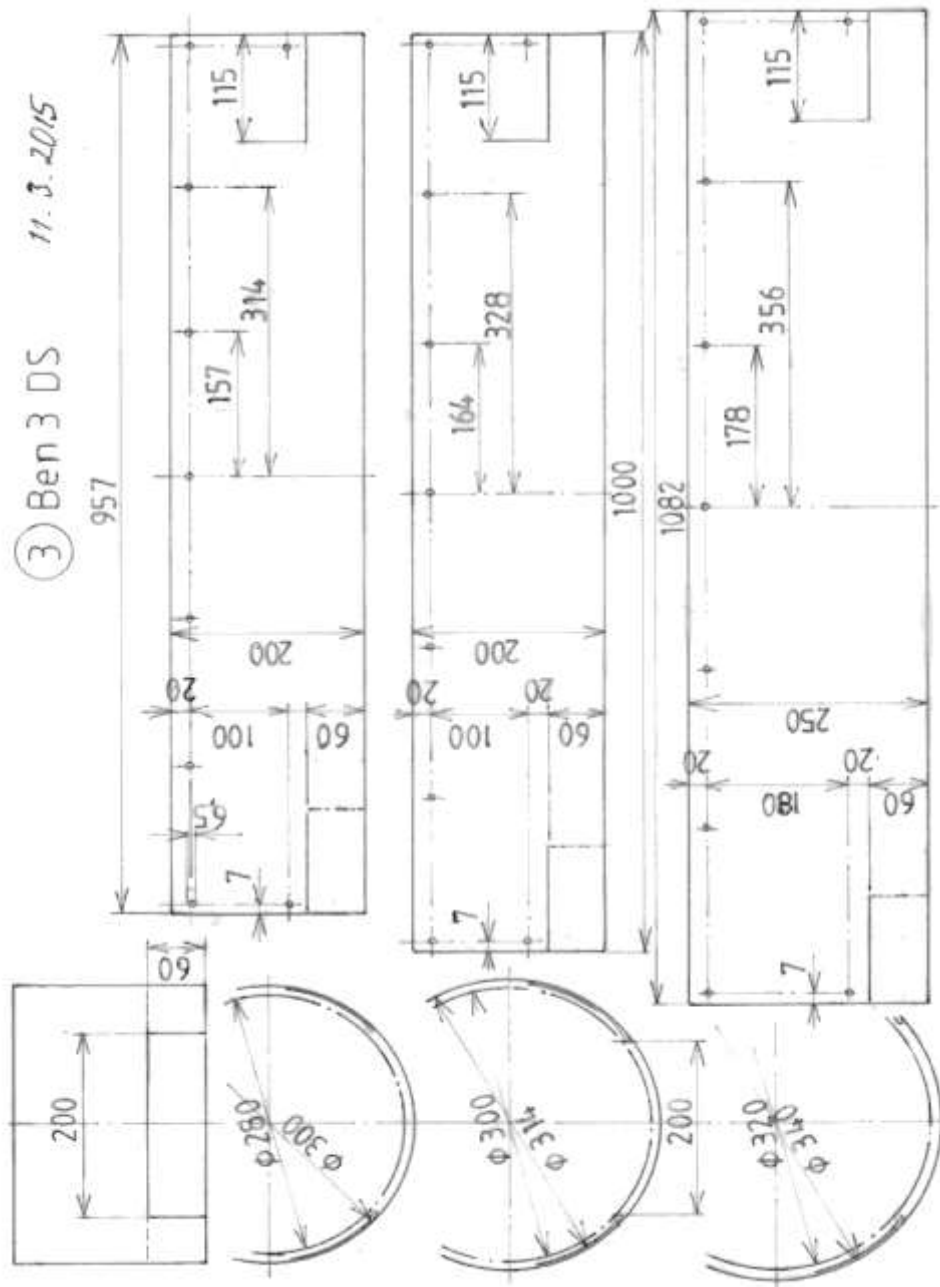

Fig. 3b. Details Ben 3: Stove Shell (3)
(April 2015 and May 2016)

Please see Annex E) for the recommended alternative tripod (4W) made of round steel and its production.



Ben 3 with tripod with welded round steel legs (May 2016)

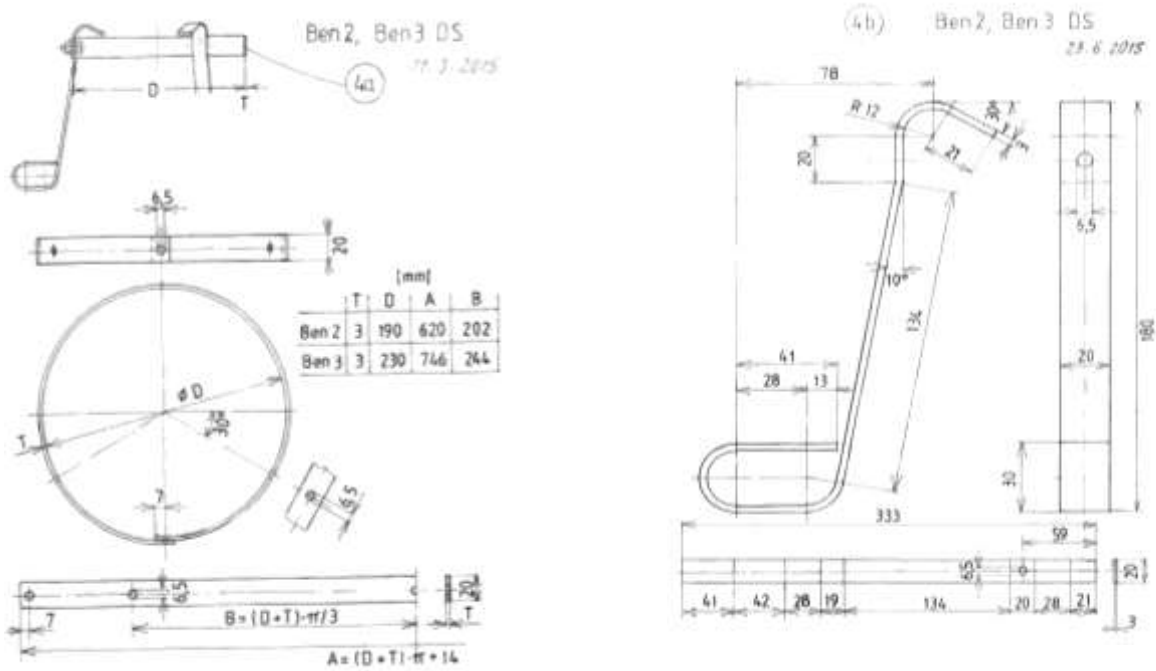

Fig. 4. Details Ben 2 and Ben 3: Tripod Ring (4a) and Tripod Leg (4b) (April 2015)

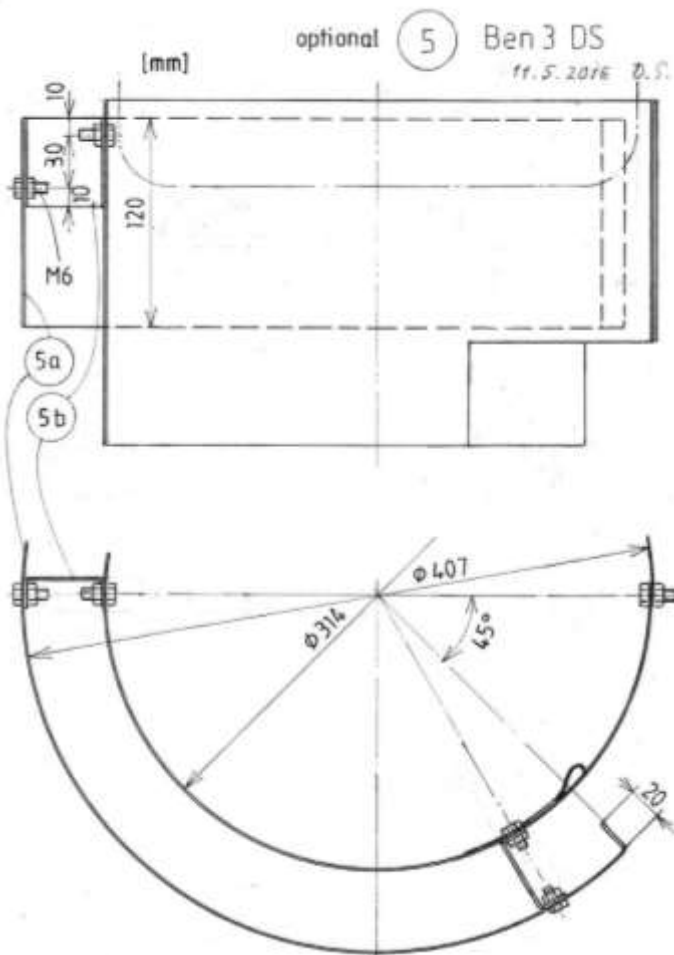
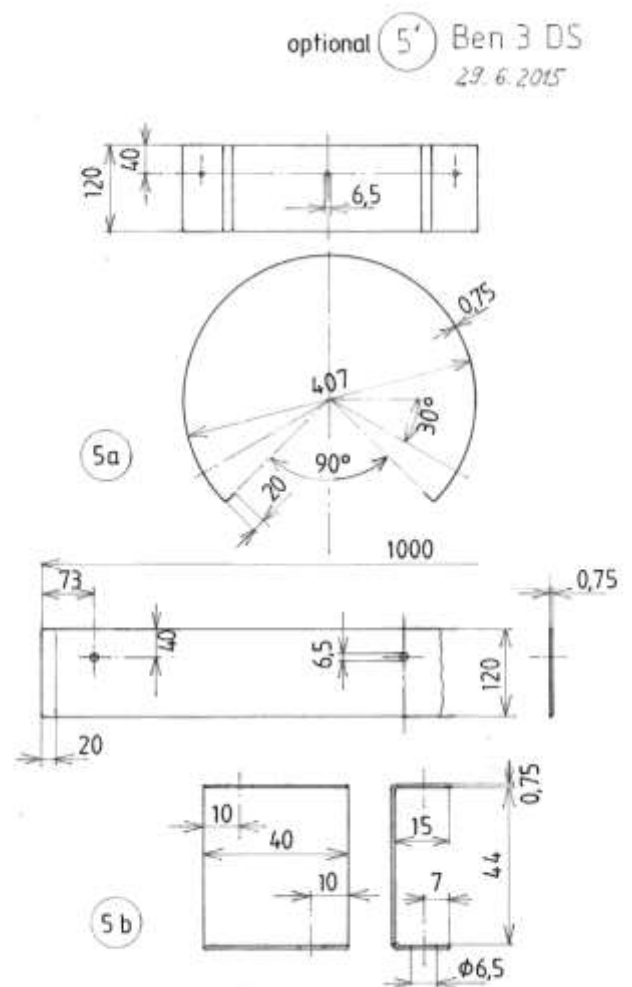

Fig. 5. Ben 3 stove shield (5) (optional)
(April 2015 and May 2016)



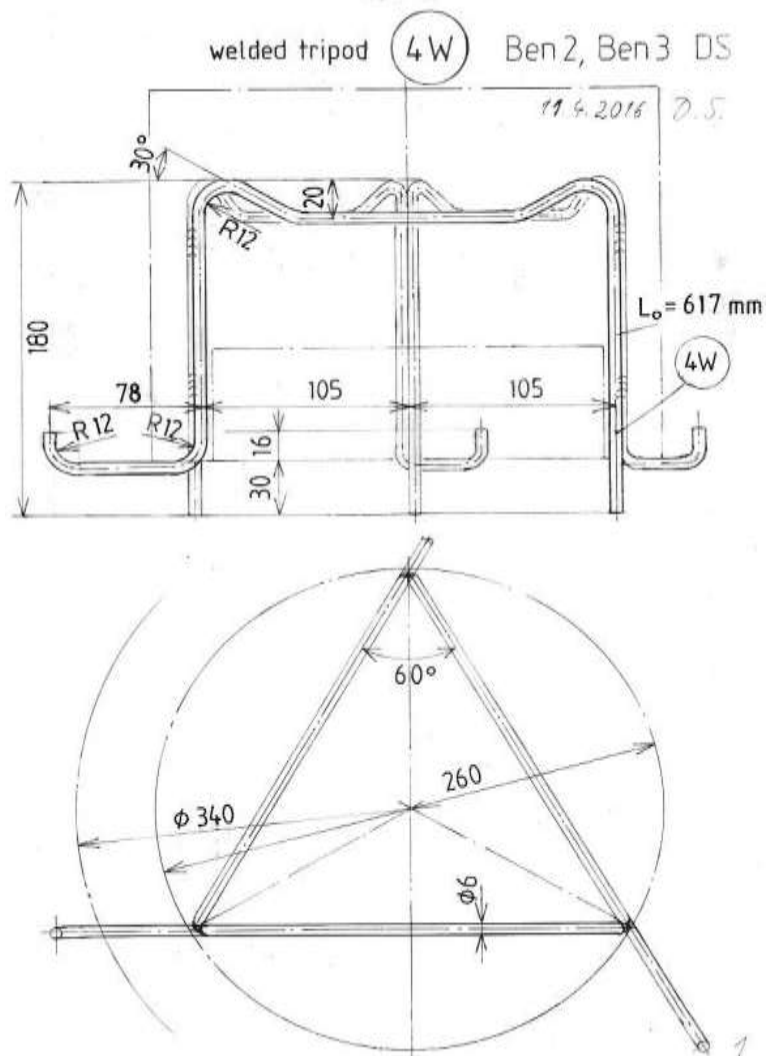

Fig. 5: Welded Tripod, see Annex E)
(May 2016)

List of Parts Ben 2 and Ben 3				04.05.2016	Dr.-Ing. Dieter Seifert						
Part Number	Number of Pieces	Name	Date of drawing./ standard	Material	Thickness or diameter	Width	Length	Cross section	Weight per part	Total weight	
					mm	mm	mm	mm ²	kg	kg	
Ben 2: for pot diameter 20cm, 24cm, 28cm and for pans and woks											
1	1	Ash Pan	11.03.2015	galvanized steel sheet	0,75	250	500		0,816	0,816	
2	4	Grate (hairpin shaped)	11.03.2015	round bar steel	6		297	28,3	0,066	0,262	
3	1	Stove Shell example for 24cm Pot	11.03.2015	galvanized steel sheet	0,75	200	830		1,083	1,083	
3d	1	Stove Shell for Pans etc.	11.03.2015	galvanized steel sheet	0,75	150	830		0,812	0,812	
4W	3	Tripod leg	11.04.2016	round bar steel	6		617	28,3	0,136	0,408	
optional 5a	1	Stove Shield	29.06.2015	galvanized steel sheet	0,75	120	830		0,650	0,650	
optional 5b	3	Shield Fastener	29.06.2015	galvanized steel sheet	0,75	40	75		0,020	0,059	
6	10	Screw M6x16	DIN 933	galvanized steel					0,003	0,030	
7	13	Nut M6	DIN 934	galvanized steel					0,002	0,026	
8	2	Spanner for 10 mm wrench size	Annex D) page 7	galvanized steel							
9	1	Nipper (for handling hot stove pieces)	Annex D) page 7	galvanized steel							
									total kit:	kg 4,25	
Part Number	Number of Pieces	Name	Date of drawing./ standard	Material	Thickness or diameter	Width	Length	Cross section	Weight per part	Total weight	
Ben 3: for pot diameter 28cm, 30cm, 32cm and for pans and woks					mm	mm	mm	mm ²	kg	kg	
1	1	Ash Pan	11.03.2015	galvanized steel	0,75	250	400		0,653	0,653	
2	4	Grate (hairpin shaped)	11.03.2015	round bar steel	6		331	28,3	0,073	0,292	
3	1	Stove Shield example for 30cm Pot	11.03.2015	galvanized steel sheet	0,75	200	1000		1,305	1,305	
3d	1	Stove Shield for Pans etc.	11.03.2015	galvanized steel sheet	0,75	150	1000		0,979	0,979	
4W	3	Tripod leg	11.04.2016	round bar steel	6		617	28,3	0,136	0,408	
optional 5a	1	Stove Shield	29.06.2015	galvanized steel sheet	0,75	120	1000		0,783	0,783	
optional 5b	3	Shield Fastener	29.06.2015	galvanized steel sheet	0,75	40	75		0,020	0,059	
6	10	Screw M6x16	DIN 933	galvanized steel					0,003	0,030	
7	13	Nut M6	DIN 934	galvanized steel					0,002	0,026	
8	2	Spanner for 10 mm wrench size	Annex D) page 7	galvanized steel							
9	1	Nipper (for handling hot stove pieces)	Annex D) page 7	galvanized steel							
									total kit:	kg 4,63	